

LA SELVA BEACH PHASE III MAIN REPLACEMENTS
 2,685 L.F. 6" CL. 200 PVC WATER MAIN, w/VALVES & FITTINGS
 890 L.F. 8" CL. 200 PVC WATER MAIN, w/VALVES & FITTINGS
 100 L.F. 6" CL. 50 DI WATER MAIN, w/VALVES & FITTINGS
 220 L.F. 2" P.E. TUBING SDR-9 200 PSI WATER MAIN, w/VALVES & FITTINGS
 72 STANDARD DOMESTIC SERVICE REPLACEMENTS
 4-2" FIRE AND DOMESTIC COMBINED SERVICE LINE RECONNECTIONS
 2-2" SINGLE FIRE SERVICE LINE RECONNECTION
 1-EXISTING DOMESTIC SERVICE ABANDONMENT
 6 JONES J-3740 FIRE HYDRANTS
 4 ABANDONMENTS OF EXISTING WHARF HEAD HYDRANTS
 3 PERMANENT BLOW-OFF ASSEMBLIES
 2 AIR/VACUUM RELEASE VALVES
 6 TIE-INS TO EXISTING WATER MAINS
 1 ABANDONMENT OF 2 1/2" WATER MAIN FROM ESTRELLA AVE. TO MAREA AVE.
 ABANDONMENTS OF ALL EXISTING MAIN CONNECTION FITTINGS & VALVES, AND
 OTHER EXISTING ISOLATION VALVES AS RELATED TO MAIN REPLACEMENTS
 51,740 S.F. TYPE II SLURRY SEAL

WATERWORKS NOTES:

1. ALL WATERWORKS RELATED CONSTRUCTION SHALL BE PERFORMED IN ACCORDANCE WITH THE STANDARD SPECIFICATIONS AND STANDARD PLANS, AND THE DIRECTIONS OF THE CHIEF ENGINEER OF THE SOQUEL CREEK WATER DISTRICT. A COPY OF THE SOQUEL CREEK WATER DISTRICT STANDARD SPECIFICATIONS AND STANDARD PLANS SHALL BE AVAILABLE ON THE JOB SITE AT ALL TIMES. COPIES MAY BE OBTAINED AT THE OFFICES OF THE SOQUEL CREEK WATER DISTRICT, 5180 SOQUEL DRIVE, SOQUEL, CA 95073.
2. THE CONTRACTOR SHALL NOTIFY THE CHIEF ENGINEER OF THE SOQUEL CREEK WATER DISTRICT A MINIMUM OF 2 WORKING DAYS PRIOR TO COMMENCING WORK. THE CONTRACTOR SHALL SCHEDULE ALL INSPECTIONS WITH THE SOQUEL CREEK WATER DISTRICT A MINIMUM OF 24 HOURS IN ADVANCE OF NEEDING SUCH INSPECTION. ALL VALVES SHALL ONLY BE OPERATED BY THE PERSONNEL OF THE IMPROVEMENTS TO THE EXISTING SOQUEL CREEK WATER DISTRICT. SYSTEM SHUTDOWNS FOR THE INTERCONNECTION OF NEW IMPROVEMENTS TO THE EXISTING SYSTEM SHALL BE SCHEDULED WITH THE SOQUEL CREEK WATER DISTRICT A MINIMUM OF 3 WORKING DAYS IN ADVANCE FOR RESIDENTIAL AREAS AND 5 WORKING DAYS IN ADVANCE FOR COMMERCIAL AND INDUSTRIAL AREAS.

Notes:

1. This is not a boundary or topographic survey. Right of way as shown is compiled from record data and reconciled to best fit random found monuments. Lot lines are generated from assessor's maps.
2. Utilities shown are based on surface evidence, USA marked locations and/or record drawing locations as provided by agencies. No potholing or verification of underground locations has been performed. Contractor shall be responsible for verification prior to construction.

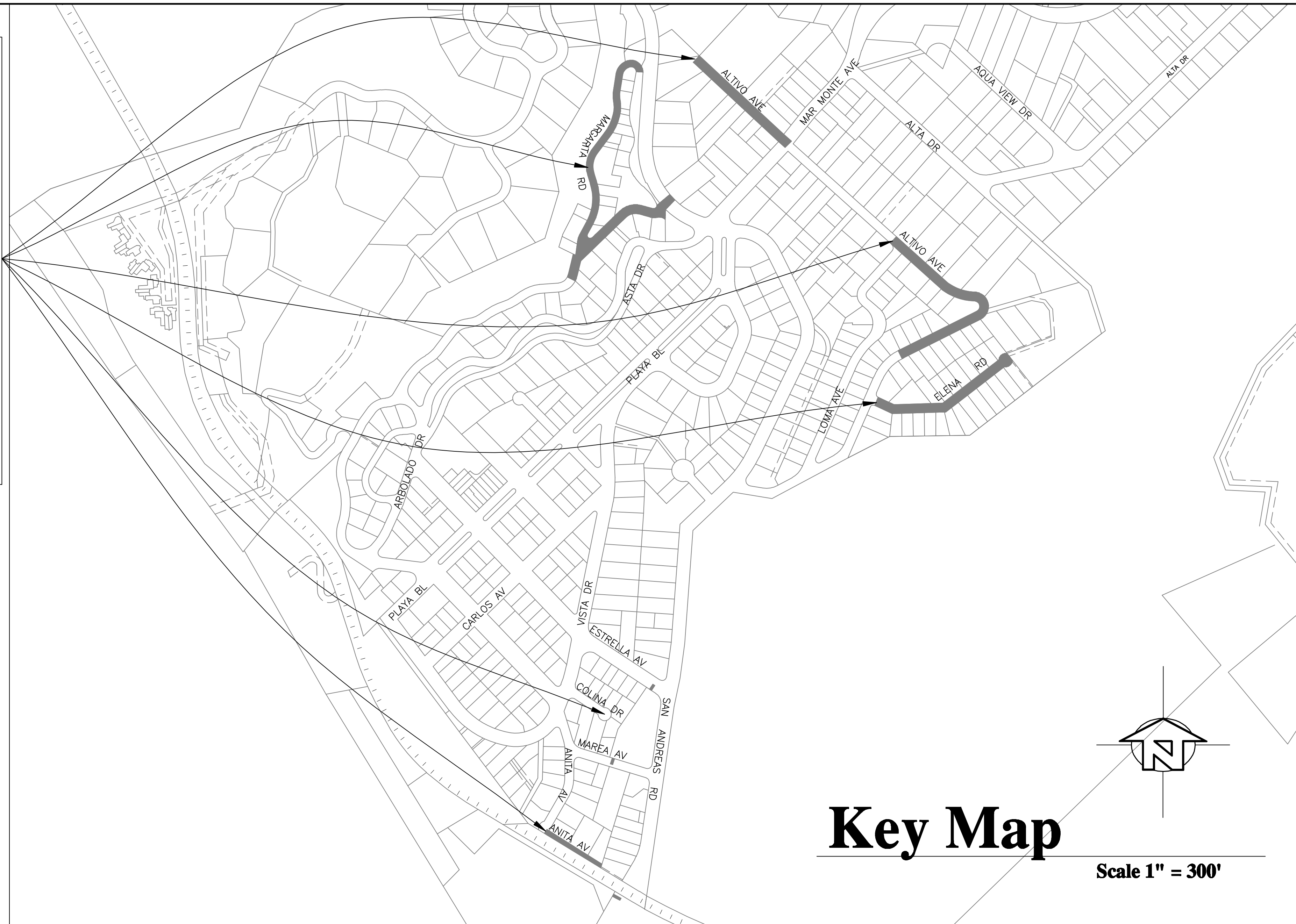

Key Map

Scale 1" = 300'

	6" PVC CL 200		EXISTING WATER MAIN
	4" GAS		EXISTING GAS SERVICE PIPE
	6" SS		EXISTING SANITARY SEWER MAIN
	18" SD		EXISTING STORM DRAIN MAIN
	1" T		EXISTING TELEPHONE CONDUIT
	1" E		EXISTING ELECTRICAL CONDUIT
	1" E&TV		EXISTING ELECTRICAL & CABLE TELEVISION
	1" TV		EXISTING CABLE TELEVISION
	1" E(O/H)		EXISTING ELECTRICAL (OVERHEAD)
	1" T&E&TV(O/H)		EXISTING TELEPHONE, ELECTRICAL & CABLE TELEVISION (OVERHEAD)
	1" T(O/H)		EXISTING TELEPHONE (OVERHEAD)
	PROPERTY LINE		CENTER LINE
	RIGHT-OF-WAY / PROPERTY LINE		EDGE OF PAVEMENT (EOP)
	CONCRETE CURB & GUTTER		CONCRETE CURB, GUTTER AND SIDEWALK
	FENCE		STREET ADDRESS NUMBER
	STANDARD DOMESTIC CUSTOMER SERVICE		MAILBOX
	DUAL DOMESTIC AND FIRE SERVICE		TREE
	GATE VALVE		SHRUB
	BUTTERFLY VALVE		SIGN
	REDUCER		CHLORINATION TAP
	FIRE HYDRANT		BLOW-OFF
	TRANSITION COUPLING OR FCA		UTILITY POLE
	MANHOLE (4" DIA. TYP.)		STORM DRAIN INLET
	GAS VALVE		UTILITY BOX
	UTILITY BOX		CAL TRANS TYPE II SLURRY SEAL BOUNDARY

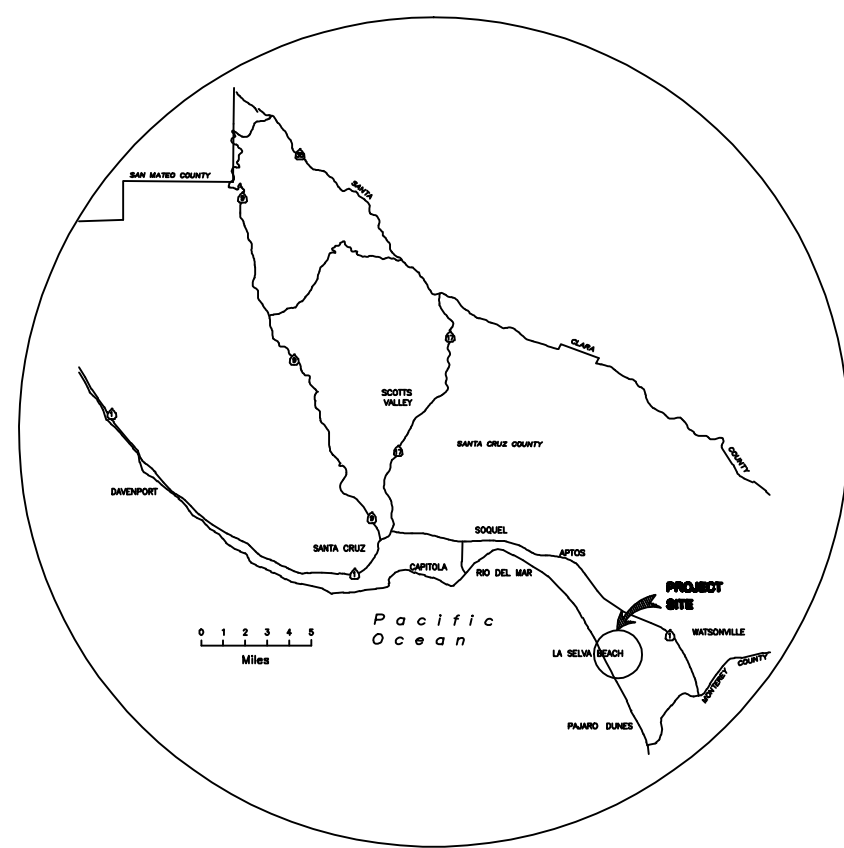

Vicinity Map

Not to Scale

Sheet Index

Key Map	Sheet 1
Elena Rd. & Altivo Ave.	Sheet 2
Altivo Ave.	Sheet 3
Altivo Ave.	Sheet 4
Margarita Rd.	Sheet 5
Margarita Rd.	Sheet 6
Anita Ave.	Sheet 7
Abandonment: Estrella Ave. to Marea Ave.	Sheet 8

No.	Revision/Issue	Date
1	ISSUED FOR REVIEW	1/12/07
0	ISSUED FOR CONSTRUCTION	08-06-07

LA SELVA BEACH PHASE III MAIN REPLACEMENTS
 COVER SHEET
 LA SELVA BEACH, SANTA CRUZ COUNTY, CALIFORNIA
 APN: N/A
 G:\01_Proj_Current\07-126\Draw\Rev_0\0-D-1.dwg 3--07--07 11:34:36 AM tajd

SOQUEL CREEK WATER DISTRICT
 PO Box 158 Soquel, California 95073
 Phone Number: (831) 475-8500
 Fax Number: (831) 475-4291

CWO. NO. 07-126
 DATE: 1/12/07
 SCALE: AS NOTED
 DESIGN BY: TAD
 DWG. NO. D-07-2161-F

Certification:

 Jeffrey N. Gailley
 Chief Engineer
 Engineering Manager

SHEET:
D-1