

ALTA DRIVE
 3,600 (+/-) SQ-FT. OF TRENCH PAVING REPAIR
 RESET 6 VALVE COVER BOXES

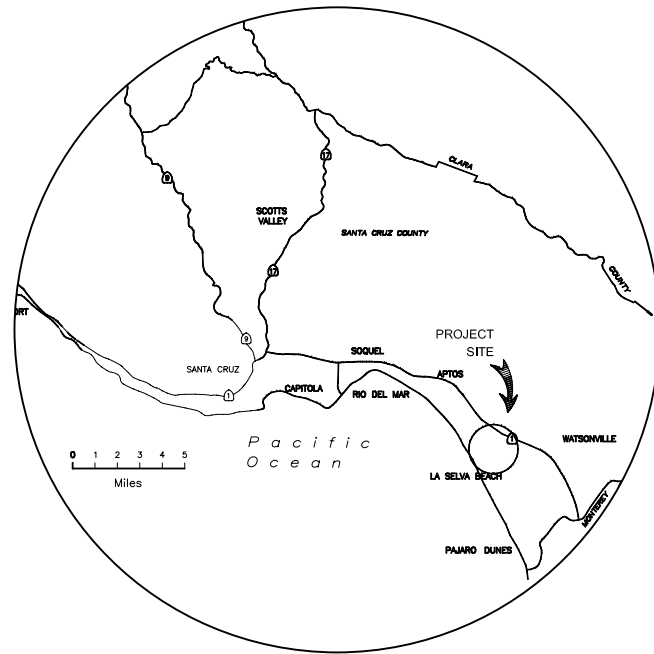

Vicinity Map

Not to Scale

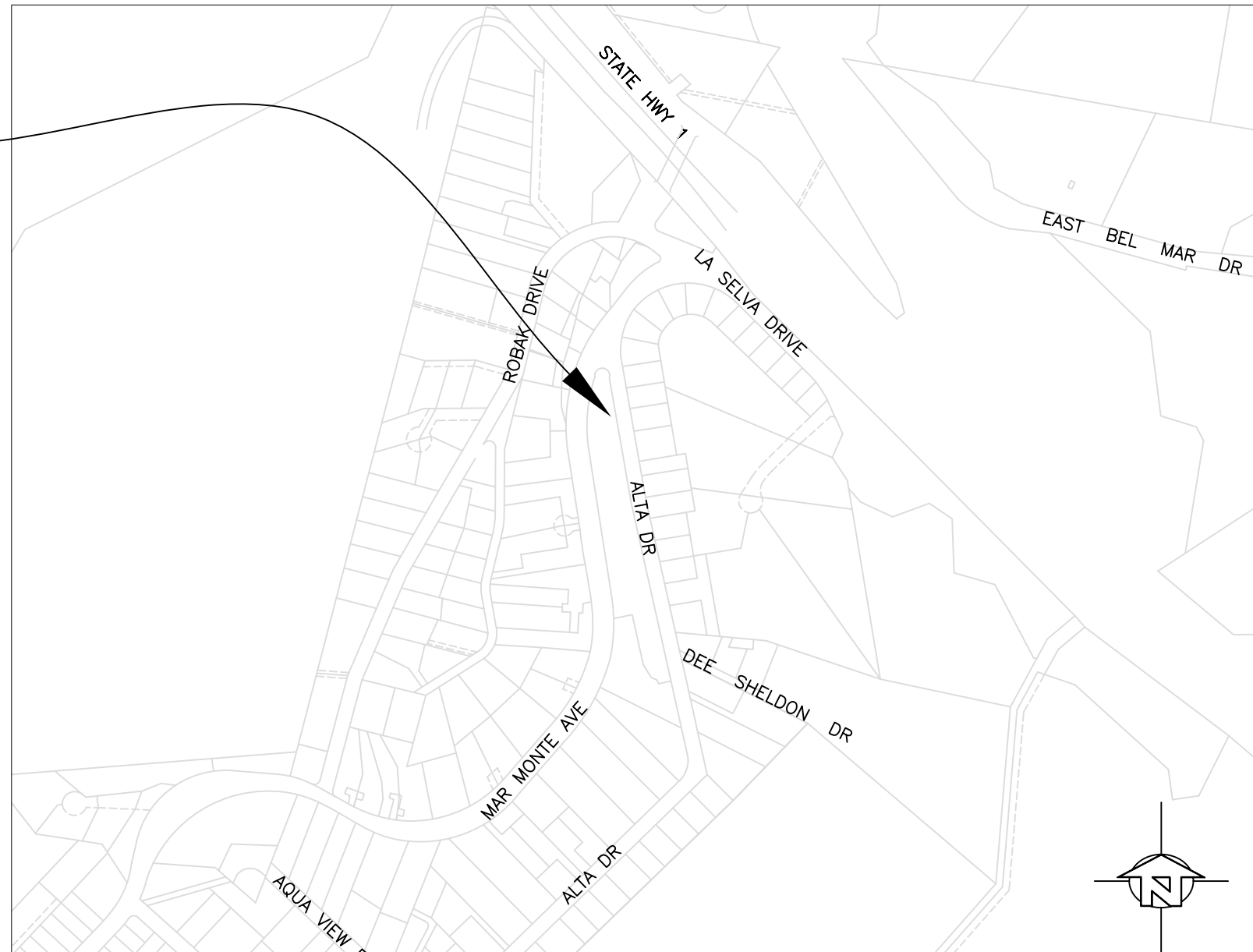

Key Map

Scale 1" = 500'

LEGEND	
	PROPOSED TRENCH PAVING REPAIR
	4" AC
	(E) WATER MAIN
	PROPERTY LINE / RIGHT-OF-WAY
	GATE VALVE
	FIRE HYDRANT
	BLOW-OFF

Water Works Notes:

1. ALL WATERWORKS RELATED CONSTRUCTION SHALL BE PERFORMED IN ACCORDANCE WITH THE STANDARD SPECIFICATIONS AND STANDARD PLANS, AND THE DIRECTIONS OF THE CHIEF ENGINEER OF THE SOQUEL CREEK WATER DISTRICT. A COPY OF THE SOQUEL CREEK WATER DISTRICT STANDARD SPECIFICATIONS AND STANDARD PLANS SHALL BE AVAILABLE ON THE JOB SITE AT ALL TIMES. COPIES MAY BE OBTAINED AT THE OFFICES OF THE SOQUEL CREEK WATER DISTRICT, 5180 SOQUEL DRIVE, SOQUEL, CA 95073.

2. THE CONTRACTOR SHALL NOTIFY THE CHIEF ENGINEER OF THE SOQUEL CREEK WATER DISTRICT A MINIMUM OF 2 WORKING DAYS PRIOR TO COMMENCING WORK. THE CONTRACTOR SHALL SCHEDULE ALL INSPECTIONS WITH THE SOQUEL CREEK WATER DISTRICT A MINIMUM OF 24 HOURS IN ADVANCE OF NEEDING SUCH INSPECTION. ALL VALVES SHALL ONLY BE OPERATED BY THE PERSONNEL OF THE SOQUEL CREEK WATER DISTRICT. SYSTEM SHUTDOWNS FOR THE INTERCONNECTION OF NEW IMPROVEMENTS TO THE EXISTING SYSTEM SHALL BE SCHEDULED WITH THE SOQUEL CREEK WATER DISTRICT A MINIMUM OF 3 WORKING DAYS IN ADVANCE FOR RESIDENTIAL AREAS AND 5 WORKING DAYS IN ADVANCE FOR COMMERCIAL AND INDUSTRIAL AREAS.

Notes:

1. THIS IS NOT A BOUNDARY OR TOPOGRAPHIC SURVEY. RIGHT OF WAY AS SHOWN IS COMPILED FROM RECORD DATA AND RECONCILED TO BEST FIT RANDOM FOUND MONUMENTS. LOT LINES ARE GENERATED FROM ASSESSOR'S MAPS.

2. UTILITIES SHOWN ARE BASED ON SURFACE EVIDENCE, USA MARKED LOCATIONS AND/OR RECORD DRAWING LOCATIONS AS PROVIDED BY AGENCIES. NO POTHOLING OR VERIFICATION OF UNDERGROUND LOCATIONS HAS BEEN PERFORMED. CONTRACTOR SHALL BE RESPONSIBLE FOR VERIFICATION PRIOR TO CONSTRUCTION.

Sheet Index

Key Map
 Alta Drive Trench Paving
 Repair

Sheet 1
 Sheet 2

ALTA DRIVE TRENCH PAVING REPAIR

No.	Revision/Issue	Date
A	ISSUED FOR REVIEW	05/05/06
0	ISSUED FOR CONSTRUCTION	05/16/06

LA SELVA BEACH, SANTA CRUZ COUNTY, CALIFORNIA

APN: N/A

G:\01_Proj_Current\06-38\Draw\Rev_0\B-1.dwg 5-18-06 08:16:58 AM CarolC

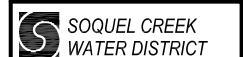

SOQUEL CREEK
 WATER DISTRICT
 PO Box 158 Soquel, California 95073
 Phone Number: (831) 475-8500
 Fax Number: (831) 475-4291

REVIEWED BY:
 O.E.M.
 DATE

CWO. NO. 06-38
 DATE: 05/03/05
 SCALE: AS NOTED
 DESIGN BY: MJW

SHEET
B-1

DWG. NO. B-06-2154-H

Certification:

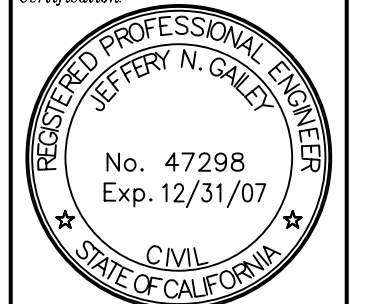

Jeffery N. Gailey
 Chief Engineer
 Engineering Manager