

SERVICES:
 REPLACE 4 WITH 1" PE TUBING AND B-9 METER BOX (9281, 9303, 9292, 9310 MONROE)
 RECONNECT 2 TO NEW MAIN (9285 & 9272 MONROE)
 AT 9525 INSTALL NEW SERVICE FROM EXISTING 8" C.I. MAIN TO EXISTING METER LOCATION (EXISTING SERVICE TO BE ABANDONED WHEN 4" C.I. IS ABANDONED)

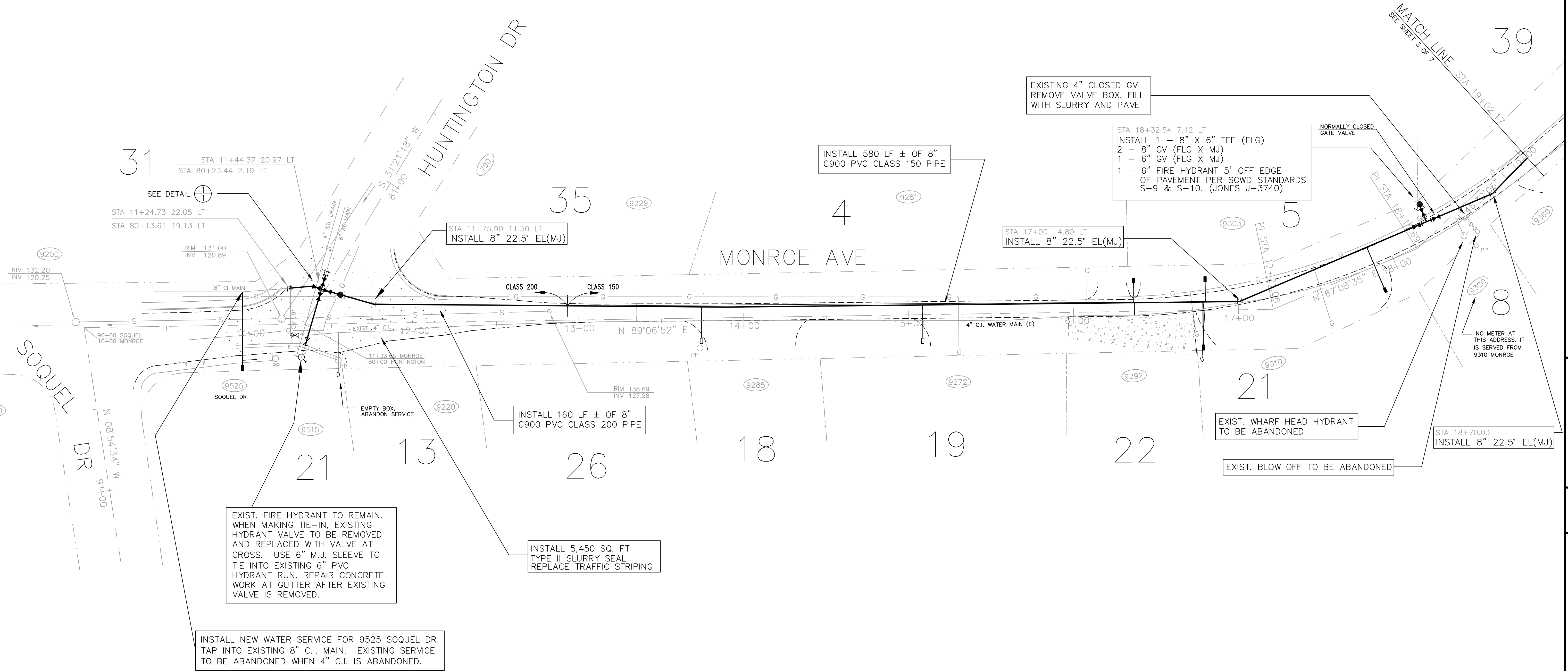
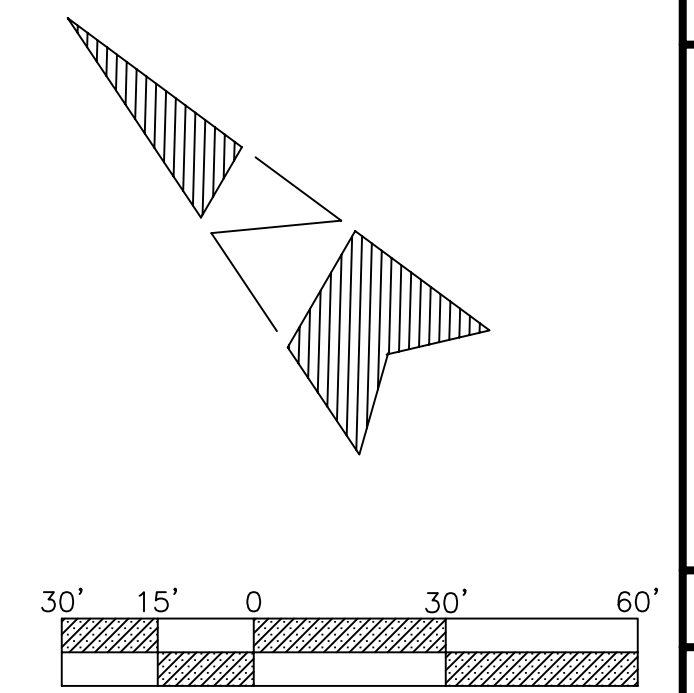

No.	Revision/Issue	Date
A	ISSUED FOR APPROVAL	02/17/04
0	ISSUED FOR CONSTRUCTION	02/17/04

MONROE AVENUE MAIN REPLACEMENT

SOQUEL CREEK WATER DISTRICT
 PO Box 158 Soquel, California 95073
 Phone Number: (831) 475-8500
 Fax Number: (831) 475-4281

CWO. NO. 03-120
 DATE: 10/30/02
 SCALE: 1" = 30'
 DESIGN BY: TAD
 DWC. NO. D-03-2113-F

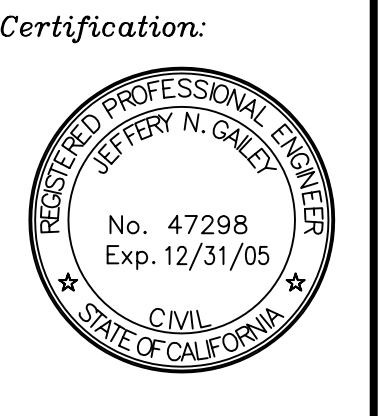

Jeffery N. Gailey
 Chief Engineer
 Engineering Manager

SHEET:
D-2

APTOX, SANTA CRUZ COUNTY, CALIFORNIA
 APN: N/A
 G:\01_Proj_Current\03-120\Draw\Rev_0\0-2.dwg 2-24-04 08:58:51 AM tojd